

Elmōnt Ave

Wilmington Ave

W. Irsey Pkwy

N Broadway St



# 2020 Census Redistricting Data (Public Law 94-171)

Noah Nelkin  
35

The U.S. Census Bureau provides the 50 states, the District of Columbia, and Puerto Rico with population counts to use in their redrawing of congressional and state legislative district boundaries — a process known as “redistricting.”

## 2010-2020 ANNUAL GROWTH RATE



**0.55%**  
Population



**0.00%**  
Group Quarters



**0.47%**  
Households

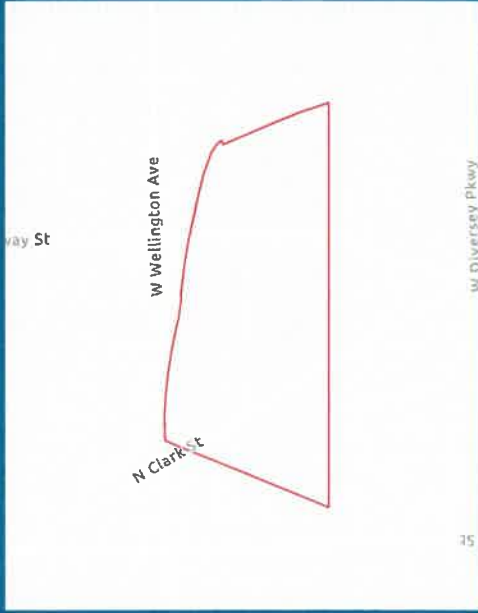

Source: U.S. Census Bureau, 2020 Redistricting Data (PL 94-171). U.S. Census Bureau 2010 decennial Census data converted by Esri into 2020 geography.



## KEY FACTS

**1,969**  
Total Population

**1,339**  
Housing Units

**59,323.3**  
Population Density

**1.55**  
Average Household Size

**49.1**  
Diversity Index

## HOUSEHOLD POPULATION

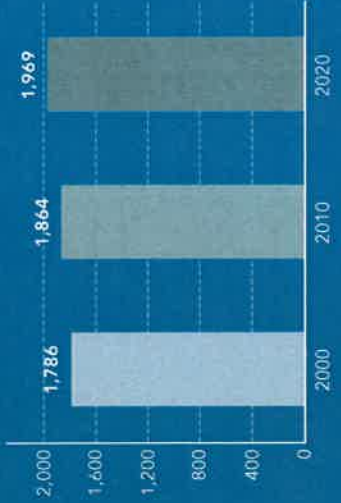

## TOTAL POPULATION BY RACE

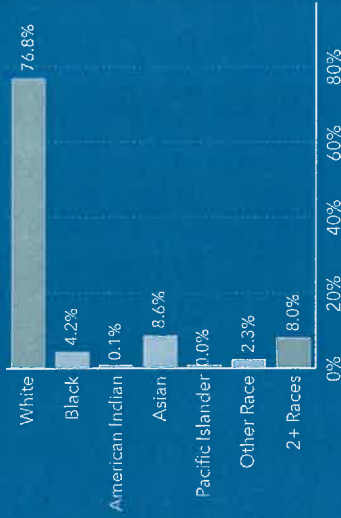

## GROUP QUARTERS

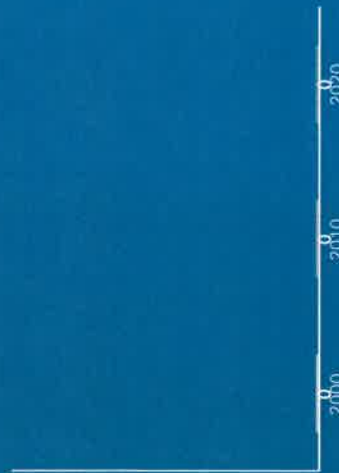

POPULATION BY AGE AND RACE	Less Than 18 Years	18 Years and Older
Total	124	1,845
1 Race	103	1,709
White	85	1,427
Black	3	79
American Indian/Alaska Native	2	2
Asian	11	158
Pacific Islander	0	0
Some Other Race	2	43
2 or More Races	21	136

# 2020 Census Redistricting Data (Public Law 94-171)

Noah Nelkin  
35

The U.S. Census Bureau provides the 50 states, the District of Columbia, and Puerto Rico with population counts to use in their redrawing of congressional and state legislative district boundaries – a process known as “redistricting.”

## GROUP QUARTERS BY POPULATION

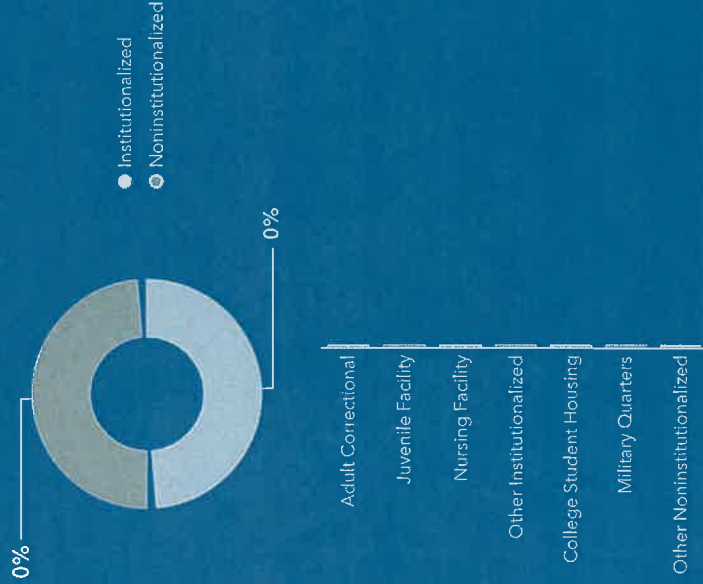

Source: U.S. Census Bureau, 2020 Redistricting Data (P.L. 94-171). U.S. Census Bureau, 2010 decennial Census data converted by Esri into 2020 geography.



Source: This infographic contains data provided by U.S. Census, Esri. The vintage of the data is 2020, 2000, 2010.

## KEY FACTS

**1,969**

Total Population

**1,339**

Housing Units

**59,323.3**

Population Density

**1.55**

Average Household Size

**49.1**

Diversity Index

HISPANIC POPULATION BY AGE AND RACE	Less Than 18 Years	18 Years and Older	Total
Total	19	154	173
1 Race	5	93	98
White	2	49	51
Black	0	4	4
American Indian/Alaska Native	0	2	2
Asian	2	0	2
Pacific Islander	0	0	0
Some Other Race	2	38	39
2 or More Races	14	61	75

NON-HISPANIC POPULATION BY AGE AND RACE	Less Than 18 Years	18 Years and Older	Total
Total	105	1,692	1,796
1 Race	98	1,616	1,714
White	84	1,378	1,462
Black	3	75	78
American Indian/Alaska Native	2	0	2
Asian	10	158	167
Pacific Islander	0	0	0
Some Other Race	0	6	6
2 or More Races	6	75	82

**Noah Nelkin – Self**

“Trying to have more Lake view elementary schools feed into Lincoln Park high school. that are close to Lincoln Park high school.”